

**Flat 2,
Priory Lodge,
Kew Bridge Court, W4**
Approx. Gross Internal Area *
665 Ft² - 61.78 M²

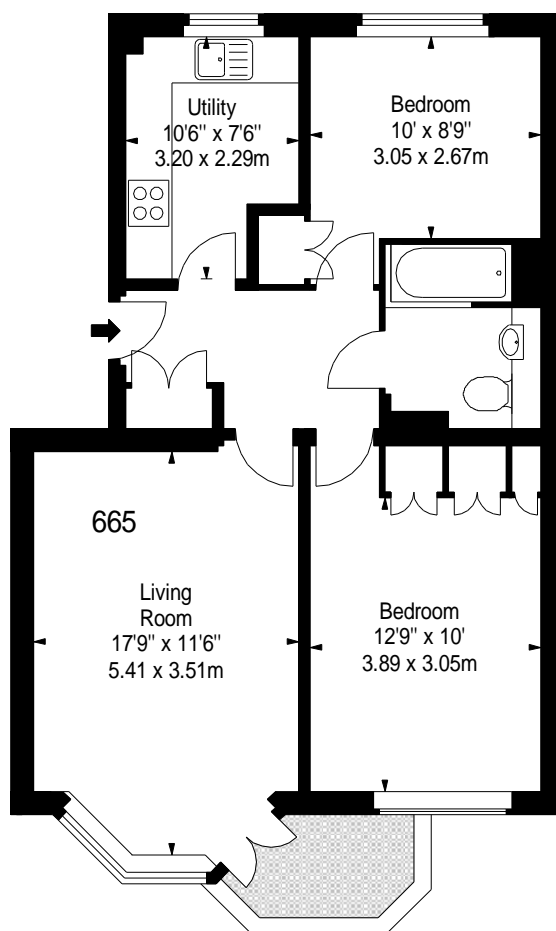

Ground Floor

Illustration For Identification Purposes Only. Not to Scale

* As Defined by RICS - Code of Measuring Practice

B K R
FLOORPLANS

(OFFICES THROUGHOUT THE UK)

T: 0845 257 2023
WWW.BKRFLOORPLANS.CO.UK

2007